

COMMUNITY NEWS



CCG

MCC

> DUNDEE ROAD LUXURY SUITES

i This newsletter is available to download online at:
WWW.C-C-G.CO.UK/COMMUNITY/SITE-INFORMATION

 @CCG_SCOTLAND

 @CCGSCOTLAND

ABOUT CCG

CCG is one of Scotland's largest privately-owned construction and manufacturing companies.

The Group employs over 800 staff spread across eight divisions including our Construction Division who will be leading this contract. With over 45 years experience, our contracts team will undertake all works promptly and as efficiently as possible with minimal impact on the surrounding community.

MCCG

Dundee Road Care Home is being constructed on behalf of a joint venture company known as Morrison Community Care (CCG) Holdco Ltd. CCG as a contractor and developer have partnered with the nationally-recognised Morrison Community Care Group to deliver modern, elderly accommodation across Scotland. We have worked together since 2017 and our new company was formed in 2021. To date we have created five developments, over 260 beds across five Local Authorities with a further three developments either underway or soon to begin construction over the next 12 months.



SCOPE OF WORKS

A new, private care home comprising 77 beds is being delivered upon a site located at Dundee Road, Perth. Works officially commence 04/09/23 and will work towards completion in summer 2025.

SITE ACTIVITY

CCG's first phase of activities will be to secure the perimeter and install our site office and welfare facilities. We will then clear the site of any excess materials and vegetation followed by ground excavation in order to facilitate the necessary main drainage and sewer connections as well as utilities including gas, water and electrical.

To accommodate off-site connections, a half-carriageway restriction as well as a footpath closure will be in place on Dundee Road from mid-October to mid-November. We apologise in advance for any inconvenience caused.

A road infrastructure will be installed as well as the creation of in-curtilage parking bays and as utilities progress, works will get underway on ground improvement and the installation of the care home's substructure (substructure - any structural works below ground-level). These works will begin at the end of the year - residents should expect to see the first elements of the building's structure to be installed in the spring.

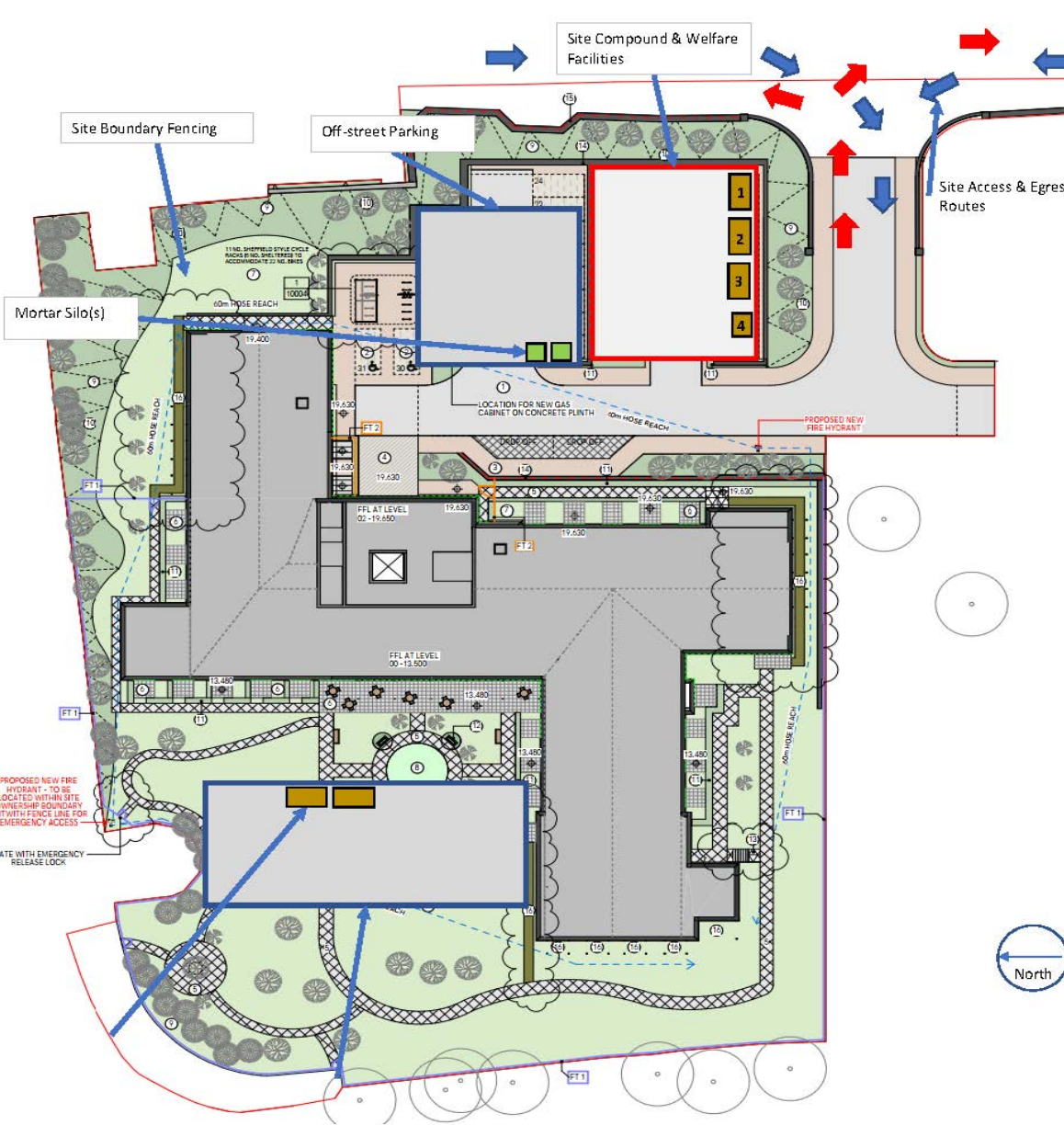

The site will be accessed from Dundee Road (A85) - as shown left. CCG's **site compound** will be positioned adjacent to the road on the northern boundary of the site with temporary accommodation also located towards the southern boundary as shown on the plan. Material laydown will be contained within the site boundary to minimise the impact of works at street-level.

Local community members are advised to be vigilant as a result of increased traffic flow in the area - CCG will have traffic management protocols in place to minimise the impact of both traffic flow and parking with a strict working schedule as well as deliveries undertaken out with peak hours whenever possible.

We will do everything we can to minimise disruption and thank you for your cooperation. We look forward to working with the local community and would invite you to reach out to us, should you have any concerns or questions, via the contact information provided below.

SAFETY

ACCESS TO THE SITE IS STRICTLY PROHIBITED



COMMUNITY ENGAGEMENT

CCG understand that engaging with the local community is important. For the duration of our time on-site, we will provide you with updates about our construction programme as well as informing you of any works that may impact your day-to-day lives - including such things as parking restrictions or road closures - via regular letter drops. Our next Site Newsletter will be published in November 2023 but should you wish to raise any questions or concerns relating to the construction activity, please revert to our Site Manager who is based at our site compound full time Monday - Friday 8.00am to 4.30pm:

Gavin Gray, Site Manager
 E: GGray@c-c-g.co.uk
 T: 07825 010767



Morrison Community Care Group
www.morrisoncommunitycare.com