

# COMMUNITY NEWS



CCG

50 YEARS

1974

2024

## > ASHGILL ROAD, MILTON

**i** This newsletter is available to download online at:  
[WWW.C-C-G.CO.UK/COMMUNITY/SITE-INFORMATION](http://WWW.C-C-G.CO.UK/COMMUNITY/SITE-INFORMATION)

 @CCG\_SCOTLAND

 @CCGSCOTLAND

## ABOUT CCG

CCG is one of Scotland's largest privately-owned construction and manufacturing companies.

The Group employs over 730 staff spread across eight divisions including our Construction Division who will be leading this contract. Our contracts team have extensive experience and will undertake all works promptly and as efficiently as possible with minimal impact on the surrounding community.

## COMMUNITY

CCG are committed to provide community investment for this project - this includes hiring new starts, work placements, curriculum support, charity donations and upskilling. This also includes a £37,200 donation to the Wheatley Foundation.

This year, we welcomed Edward Oyedare on site for a Site Management work placement (pictured below) and have hired a local tradesman.



## SCOPE OF WORKS

CCG (Scotland) is working on behalf of Lowther Homes, a member of Wheatley Group, at Ashgill Road in north Glasgow with the delivery of 48 homes for mid-market rent. Works commenced in November 2023 and are set for completion in early-2025.

## SITE ACTIVITY

Over the past 10 weeks, significant progress has been made across the development. All external site drainage connections have been made as well as all associated infrastructure for the heating system which is a ground source heat pump solution that is entirely non-gas.

All necessary foundations works have been completed which has enabled the site to commence the installation of Block 1, 2 and 3's superstructures (walls and roof structure combine to create a "superstructure"). The first elements of the superstructure are pictured above where we are using structural steel for common areas of each block. This is followed by the installation of the timber frame structure used for the wall zones and roof which will be complete at Block 2 this April followed by Block's 1 and 3 in the late spring and summer period.

Block 2 will begin to have external finishes applied in the coming weeks. This will include brick to wall zones and tiling to the roof. Internal works will also commence with 1st fix joinery (walls and ceilings), electrical and plumbing trades.

The site is accessed from Ashgill Road - as shown right. CCG's **site compound** and material lay-down areas are positioned within the site boundary; we will continue to mitigate the impact of traffic flow and parking on the surrounding community with a strict management plan that will remain in place for the duration of the construction programme. This includes an allocated parking area for site operatives which is located to the west boundary as well as the scheduling of deliveries being undertaken out with peak hours whenever possible.

Local community members are advised to be vigilant as a result of the increased traffic flow in the area.

We thank you for your ongoing cooperation. Should you have any concerns or questions, please contact our site manager via the contact information provided below.

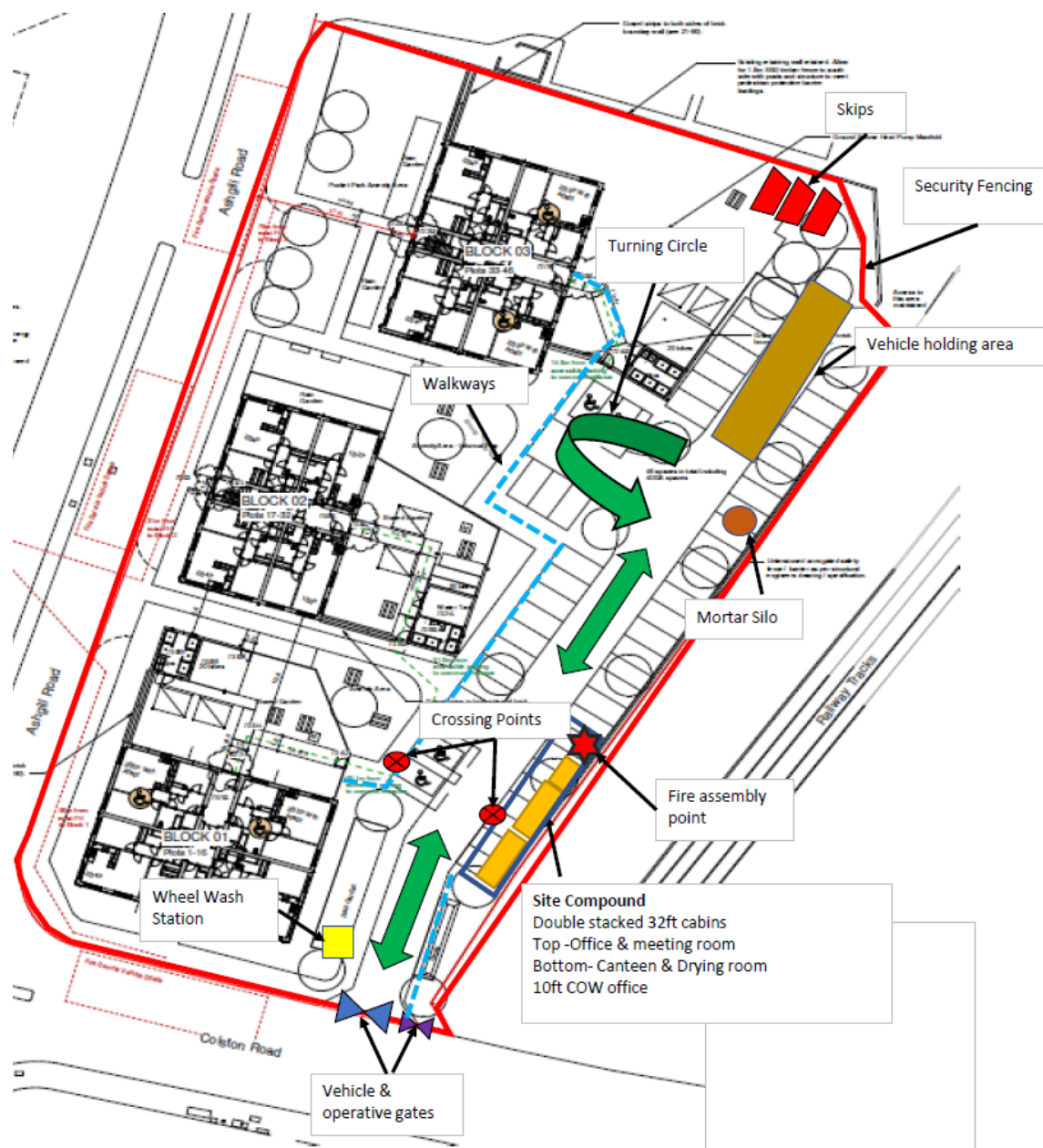

## SAFETY

**ACCESS TO THE SITE IS STRICTLY PROHIBITED**



## COMMUNITY ENGAGEMENT

CCG understand that engaging with the local community is important. For the duration of our time on-site, we will provide you with updates about our construction programme as well as informing you of any works that may impact your day-to-day lives - including such things as parking restrictions or road closures - via regular letter drops. Our next Site Newsletter will be published in June 2024 but should you wish to raise any questions or concerns relating to the construction activity, please revert to our Site Manager who is based at our site compound full time Mon – Thurs 8am – 4.30pm, Fri 8am – 3.30pm & Sat 8am – 1pm.

Kevin Stewart, Site Manager  
 E: [kstewart@c-c-g.co.uk](mailto:kstewart@c-c-g.co.uk)  
 T: 07880103455



Lowther Homes, part of  
 Wheatley Group

Wheatley House,  
 25 Cochrane St, Glasgow G1 1HL

[www.lowtherhomes.com](http://www.lowtherhomes.com)