

SCHOLARSNEWS

SITE UPDATES FROM CCG HOMES



ccghomes.co.uk



facebook.com/CCGHomesLtd



[@CcgHomes](https://twitter.com/CcgHomes)



[@ccgHomes](https://instagram.com/ccgHomes)

CCG
HOMES



SCOPE OF WORKS

CCG Homes is a multi-award-winning private housing developer and is part of the CCG Group. We are responsible for the re-development of the former Greenock Academy site located on Madeira Street known as The Scholars where we will be creating 30, three-and-four-bedroom homes for private sale. CCG's Construction Division are managing our site-based operations with works set to be fully completed by spring-2025.

SITE ACTIVITY

The CCG Site Team has made significant progress across the development in the first quarter of the year. As residents will note, Block's 2, 7 and 8 on Newark Street are now in place with external finishes to the walls and roof also set to be fully completed by the end of May. Internal trades such as joinery, electrical and plumbing will advance the programme into the summer period with Plot 30 of Block 8 set to be the very first to be handed over and utilised as a show home in August. In advance of this date, the CCG Homes Sales Team will be based from a temporary marketing suite from mid-May.

Road reinstatement works on Newark Street will be completed wk. ending 19/04 with attention turning to Madeira Street where new drainage connections will commence before the end of the month. These works will require a partial road closure stretching from Newark Street to Brisbane Street for an estimated duration of six weeks - we apologise in advance for the inconvenience caused.

Over the coming weeks, construction will be advanced along the southeastern boundary of the site. Works are already underway with the erection of homes at Block 1 (shown overleaf) with Block 3 set to follow during the spring period and 4 and 5 later in the summer.

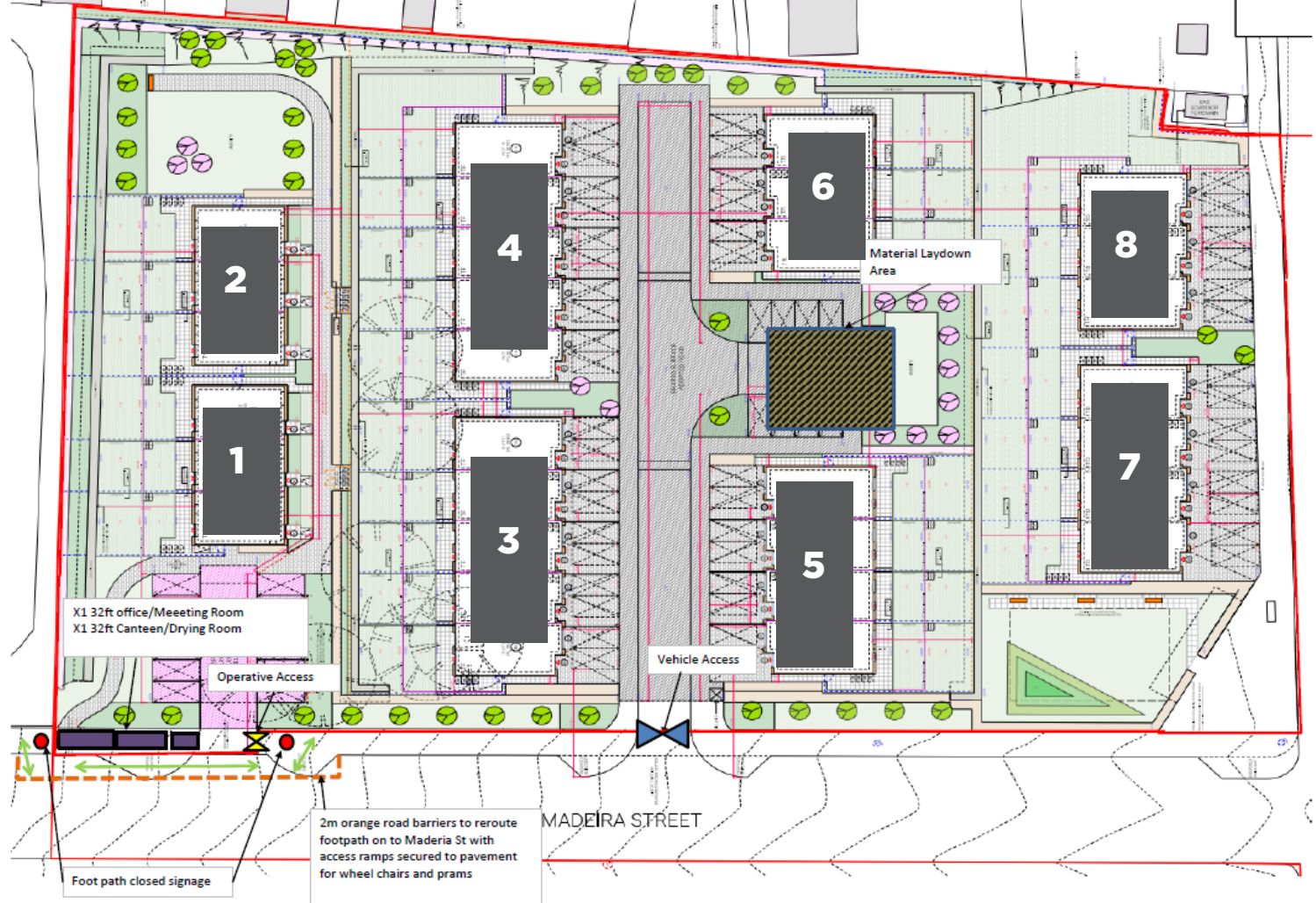

The CCG (Scotland) Site Team office and welfare facilities are located on the footpath of Madeira Street, as annotated above. The partial footpath closure will remain so for the remainder of the construction programme - we apologise for the inconvenience caused. Vehicles access to the site is taken from Madeira Street itself with all material storage contained within the boundary of the development. The Site Team has traffic management protocols in place in order to minimise disruption with deliveries undertaken out with peak hours whenever possible as well as a strict working schedule (site opening hours shown below). We will continue to mitigate the impact of works on your day-to-day lives as much as possible and thank you for your ongoing cooperation and understanding. Should you wish to raise any questions or concerns, our Site Manager can be contacted by the details provided below.

SAFETY

ACCESS TO THE SITE IS STRICTLY PROHIBITED



COMMUNITY ENGAGEMENT

CCG (Scotland) and CCG Homes will issue regular updates throughout the course of the construction programme with newsletters such as the one you have been provided or letter drops to announce any real-time announcements works that may be impactful to you day-to-day living such as road traffic restrictions. Our next Newsletter issue will be distributed in July but should any resident wish to raise questions or concerns about site operations, please contact our Site Manager via the details provided:

Jim Napier, Site Manager
 E: jnapier@c-c-g.co.uk
 P: 07787 291129

Jim is based at the CCG (Scotland) Site Team Office from Monday to Friday, 7.30am up to 6.00pm in line with ICC environmental guidelines.

SALES

If any community members are interested in purchasing a home at *The Scholars* we invite you to contact the CCG Homes Sales Team:

Head Office
 9 Cambuslang Road,
 Glasgow
 G32 8NB

Email: scholars@ccg-homes.co.uk
 Phone: 0141 643 3727
 Web: ccghomes.co.uk