

COMMUNITY NEWS



CCG

1974 50 YEARS 2024

> PINE PLACE, NEW GORBALS

i This newsletter is available to download online at:
WWW.C-C-G.CO.UK/COMMUNITY/SITE-INFORMATION

 @CCG_SCOTLAND

 @CCGSCOTLAND

ABOUT CCG

The CCG (Scotland) Group is one of Scotland's largest construction and manufacturing companies and in 2024, we are celebrating our 50th year of business. We employ over 730 staff across a range of integrated divisions, including our Construction Division who are highly experienced in the delivery of residential developments such as Pine Place.



SCOPE OF WORKS

CCG (Scotland) is working on behalf of New Gorbals Housing Association to deliver Pine Place, a new development of 28 homes in a mix of 18 flats (1-2 bedrooms) and 10 houses (4-5 bedrooms). Construction commenced on 29 April 2024, with a planned programme duration of 59 weeks.

SITE ACTIVITY

CCG has made good progress on-site over the summer period. As community members will note, the steel frame structure for the flatted block is now fully in place, and works are now underway with the installation of the underbuild (supporting build below ground level), and the steel decking for each of the floors.

Our site team has also completed the installation of drainage, public utilities and the substructure (any structure below ground-level) and foundations to the terraced housing block. Each of the homes in the terraced block will be constructed using a timber frame superstructure (superstructure – walls and roof structures combine to create a “superstructure”). Following the installation of a crane and scaffolding, works to install and erect the first homes will begin in late-September, and will lead the construction programme into the early-winter period.

The CCG Site Team give thanks to local community members for your ongoing patience and cooperation.

COMMUNITY

As main contractor, CCG has a number of obligations that we will adhere to during the course of construction programme that will extend into the community itself. Known as ‘community benefit’, this can range from job creation and engagement with local schools to financial donations towards charities or locally-based initiatives. We will update you on the progress of these obligations in our forthcoming newsletter issues.

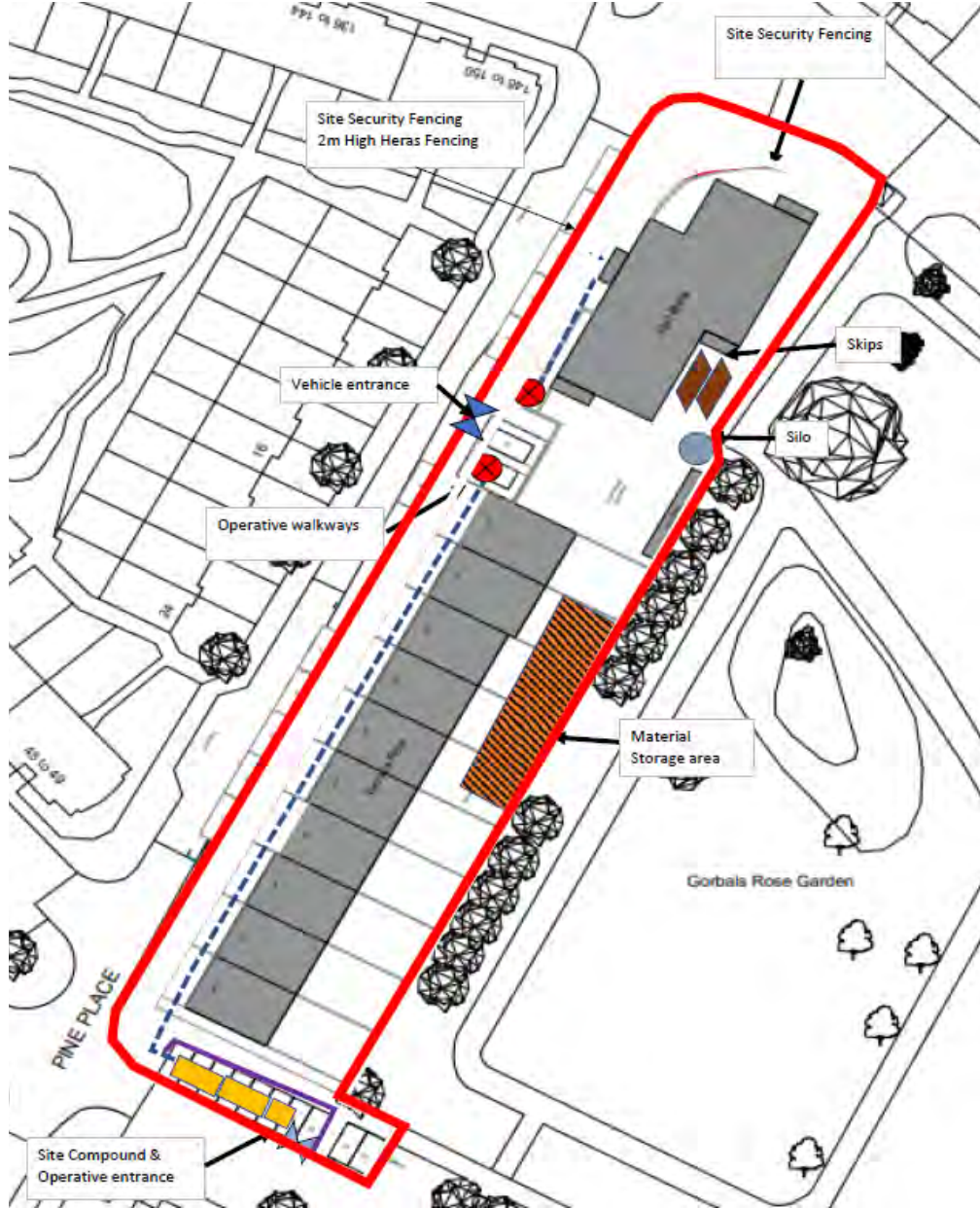

CCG site deliveries will access the development via Pine Place. All deliveries will be coordinated by traffic management protocols in order to minimise the impact of traffic flow, particularly at peak hours, as well as staff parking which will be strictly monitored for the duration of the construction programme. Our site compound and welfare facilities are contained within the site boundary - located on the corner of Pine Place and Erroll Street - as well as material storage. CCTV is in operation 24/7 and residents are free to contact our security team in the event of any site-based emergencies or issues via 0141 392 0677.

CCG would like to advise community members to remain vigilant and take extra care when moving around the site - should you wish to raise questions or concerns about our activities, please contact our Project Manager via the contact information provided below.

SAFETY

ACCESS TO THE SITE IS STRICTLY PROHIBITED



COMMUNITY ENGAGEMENT

CCG understand that engaging with the local community is important. For the duration of our time on-site, we will provide you with updates about our construction programme as well as informing you of any works that may impact your day-to-day lives including such things as parking restrictions or road closures via separate letter drops. Our next Site Newsletter will be published in November but should you wish to raise any questions or concerns relating to the construction activity, please revert to our Project Manager who is based at our site compound full time Monday - Friday 7.30am to 5.30pm.

Billy McGill, Project Manager
 E: BMcGill@c-c-g.co.uk
 T: 07876 134845

NEW
GORBALS
 HOUSING ASSOCIATION

New Gorbals Housing
 Association 200 Crown
 Street Glasgow
 G5 9AY

www.newgorbalsha.org.uk